

EARTH RETAINING WALL

APPLICATIONS :

- For the prevention of the soil erosion.
- To retain the soil nearby, Culvert, Underpass, Bridge, etc.
- To provide the stability in sloped soil.
- Landscaping.

Reinforced Concrete Unit Weight Y_c █ 24.5 kN/m
 Unit Weight of soil Y_s █ 19 kN/ms
 Angle of internal friction of soil θ █ 30°
 Overburden load q █ 10 kN/m?
 Sliding safety factor $F_s \geq 1.5$
 Eccentricity (for overturning) $|e| \leq B/6$

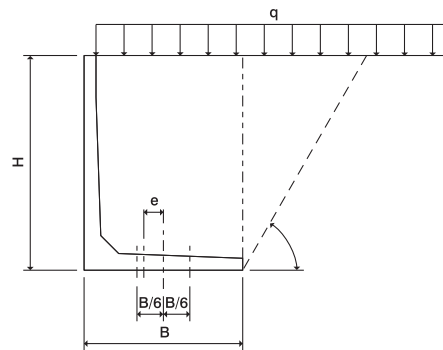

H = 600 - H = 1000

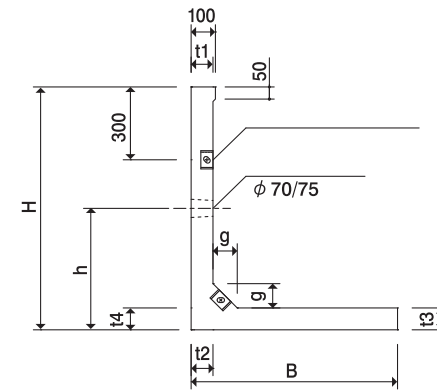

SECTION

H = 1200 - H = 2500

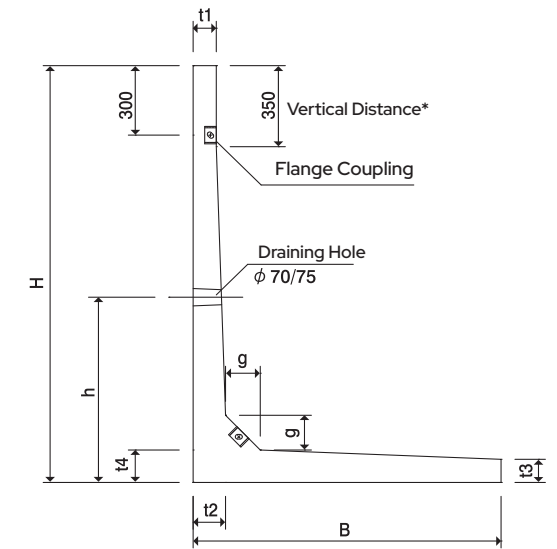

SECTION

HEIGHT (MM)	DIMENSIONS							
	B	t1	t2	t3	t4	g	h	h
600	680	70	70	70	70	100	300	2000
800	760	80	80	80	80	100	400	2000
1000	850	90	90	90	90	100	500	2000
1200	970	100	100	100	100	120	600	2000
1800	1330	100	140	100	140	150	800	2000
2000	1450	100	140	100	140	150	800	2000
2250	1600	100	170	100	170	180	900	2000
2500	1750	100	170	100	170	180	900	2000

TYPICAL FOUNDATION DETAILS

